

PRIMINER

V3320-V4020

Double Column Center



Technical Specifications	V3320	V4020
Table size	3300×1700 mm	4000×1700 mm
X/Y/Z Travel	3300/2700/1000 mm	4200×2700×1000 mm
X/Y/Z Rapid feed	20 m/min	15/20/20 m/min
Spindle standard	BT50/SK50 , 6000 rpm	
Spindle options	HSK A100, 12000 rpm/HSK A63, 18000 rpm	



RIGID MACHINE STRUCTURE

Longer Y axis travel as standard to ensure more machining capacity when using 90° milling head

40/60 pockets chain type tool changer (optional)

Three axes with roller type linear guideways

Linear scales on three axes (optional)

Available with various spindles for different application

Extra wide column

Two screw type and one chain type chip conveyor

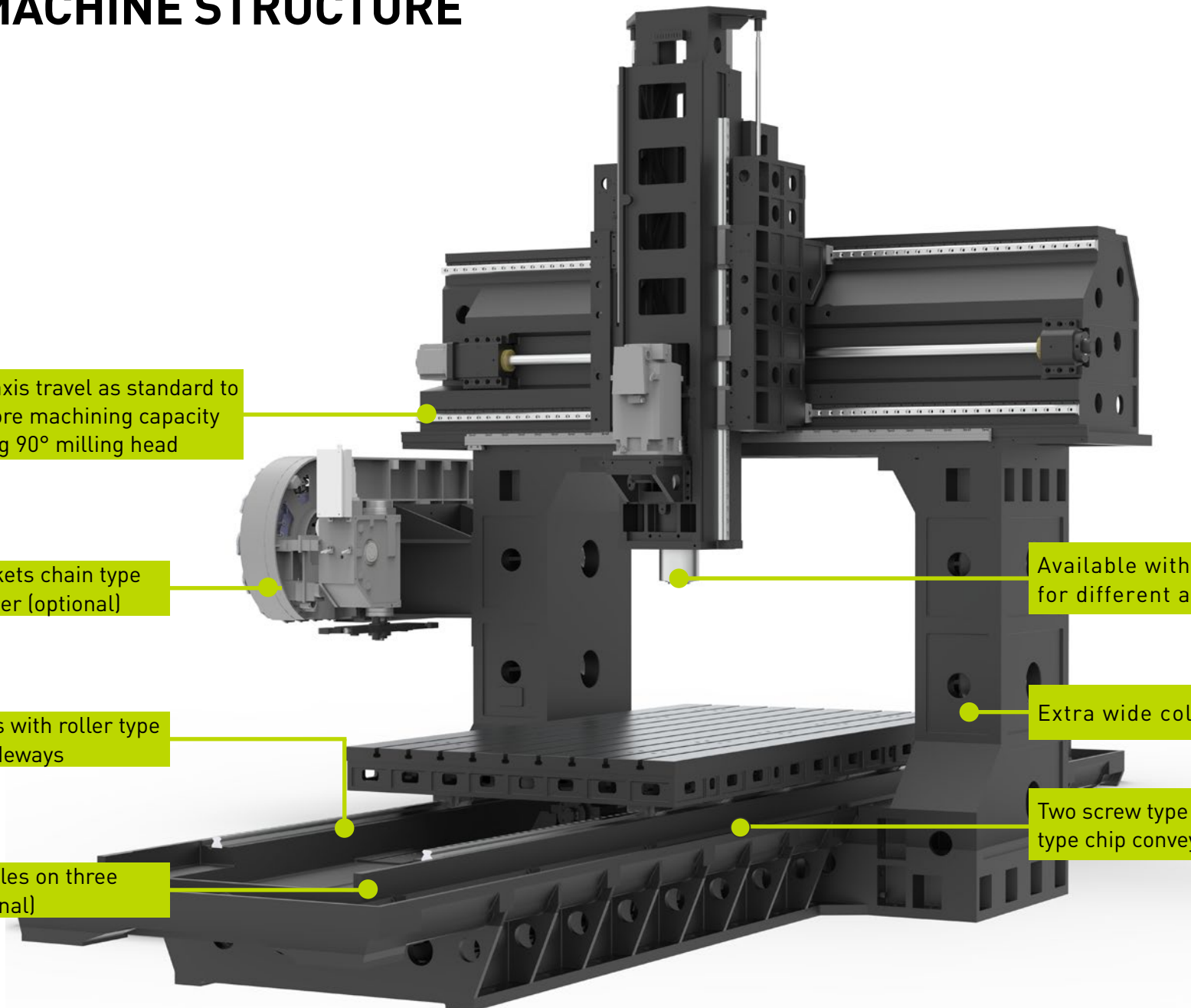

SIEMENS SINUMERIK 828D

The perfect solution for all performance classes

New Panel Processing Unit

- ✓ Higher processor performance
- ✓ Digital Input with higher voltage stability
- ✓ 1GB Ethernet interface X130
- ✓ Pull-relief for the DRIVE-CLiQ and PN cables
- ✓ More robust touch-operation 15,6" PPU290.4

Features for milling Cogging torque compensation and 2nd channel for milling

- ✓ System integrated function
 - Drive-based function SINAMICS
- ✓ Automatic measure of the cogging torque
- ✓ Pre-control of periodic repetitive torque ripple
- ✓ Function available for rotative-, linear- and torque motors
- ✓ 2nd Channel Milling
 - For both machining and handling & robot purpose

Nodding Compensation ECO/Advanced and Advanced Position Control ECO

- ✓ Intelligent control based compensation
 - New developed compensation algorithm
- ✓ System integrated function
 - ✓ As a CNC and HMI feature
- ✓ Scalable function in 3 steps
 - ECO
 - Advanced
 - Compile Cycle
- ✓ Commissioning support with HMI masks
 - Additional input mask from SINUMERIK Operate

Higher speed, more accurate for the entry level

Tool Ident Connection

Jerk Adaption

Top Speed plus

Intelligent Load Control (ILC)

Intelligent Dynamic Control (IDC)



FANUC Series 0i-MODEL F Plus

New World-Standard CNC

As a successor to the Series 0i-MODEL F, the FANUC Series 0i-MODEL F Plus has been released with renewed design, enhanced basic functions and the pursuit of ease of use.

It is equipped with the latest control technology for fine surface machining and reducing cycle time, and with customizable functions that can flexibly create screens.

- ✓ Reduced cycle time
- ✓ High-Speed, Fine Surface Machining
- ✓ Renewed design
- ✓ Equipped with +HMI (Type 0)
- ✓ Equipped with FANUC's latest CNC and servo technologies
- ✓ Comes standard with customizability functions
- ✓ Extended memory capacity
- ✓ Consistent Support at Shop Floor
- ✓ Easily use memory cards as high-capacity program memory devices
- ✓ Supported Industrial Ethernet/Field Networks
- ✓ Improvement of the safety of machine tool and machining line



TECHNICAL SPECIFICATIONS

Technical Specifications	V3320	V4020
Table		
Table size	3300×1700 mm	4000×1700 mm
T-slot (width x number x distance)	22×9×170 mm	22×11×170 mm
Max. load	8000 kg	10000 kg
Travel		
X/Y/Z Travel	3300/2700/1000 mm	4200/2700/1000 mm
Spindle nose to table	200-1200 mm(BT50/SK50) / 250-1250 mm(HSK A100) / 230-1230 mm(HSK A63)	
Distance between columns	2000 mm	
Spindle		
Spindle(standard)	BT50/SK50, 6000 rpm	
Spindle motor power and torque(SIEMENS)	22/60 kW, 172/380 Nm	
Spindle motor power and torque(FANUC)	22/45 kW, 140/286 Nm	
Spindle(option 1)	HSK A100,12000 rpm	
Spindle motor power and torque(SIEMENS)	20/22.5 kW, 298/346 Nm	
Spindle(option 2)	HSK A63,18000 rpm	
Spindle motor power and torque(SIEMENS)	26/36 kW, 124/176 Nm	
Feed		
Rapid feed X/Y/Z	20 m/min	15/20/20 m/min
Cutting speed	1-12000 mm/min	
Accuracy (VDI3441 Full travel)		
Positioning accuracy(without linear scales)	0.020/0.020/0.015 mm	0.025/0.020/0.015 mm
Positioning repeatability(without linear scales)	0.015/0.015/0.010 mm	0.020/0.015/0.010 mm
Repeatability accuracy(with linear scales)	0.015/0.015/0.010 mm	0.020/0.015/0.010 mm
Positioning repeatability(with linear scales)	0.010/0.010/0.006 mm	0.015/0.010/0.006 mm
Dimensions & Weight		
Dimensions	9672×5350×5080 mm	11516×5093×5074 mm
Weight	32000 kg	39000 kg

STANDARD /OPTIONAL CONFIGURATION

● Standard ○ Optional

Configurations	Standard	Optional
Chip conveyor (two screw type and one chain type)	●	
Spindle oil cooler	●	
BT50/SK50 Belt drive spindle 6000 rpm	●	
Spindle with BF gearbox		○
Built-in spindle HSK A100 12000rpm(only available on SIEMENS Control)		○
Built-in spindle HSK A63 18000rpm(only available on SIEMENS Control)		○
Fully enclosed splash guard		○
Linear scales on X/Y/Z axis		○
40 pockets chain type tool changer		○
60 pockets chain type tool changer		○
CTS Coolant through spindle + ATS		○
Auto Power Off		○
Tool probe		○
Tool workpiece		○
Manual 90° milling head		○
Rigid tapping	●	
Air-conditioned electrical cabinet	●	
Ethernet, CF card and USB interface	●	
Automatic lubrication system	●	
Coolant system	●	
LED working lamp	●	
End of program light	●	
Electronic handwheel (MPG)	●	
Tool box	●	
Leveling bolts and blocks	●	
Air blast during cutting	●	
Coolant gun	●	
Air gun	●	
User Manual	●	

TORQUE DIAGRAM

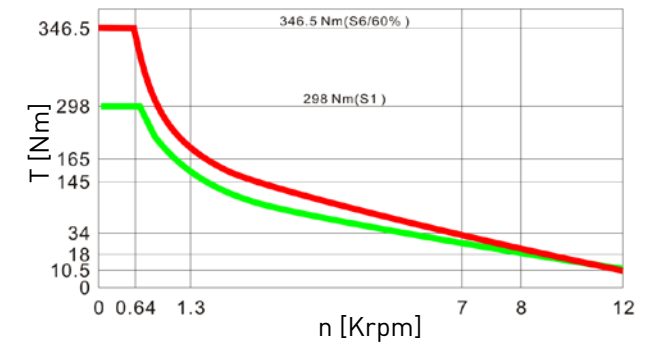
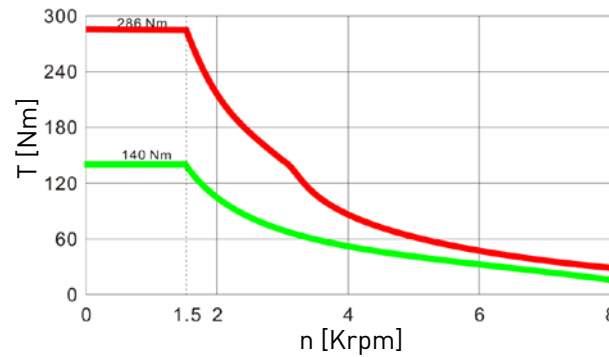
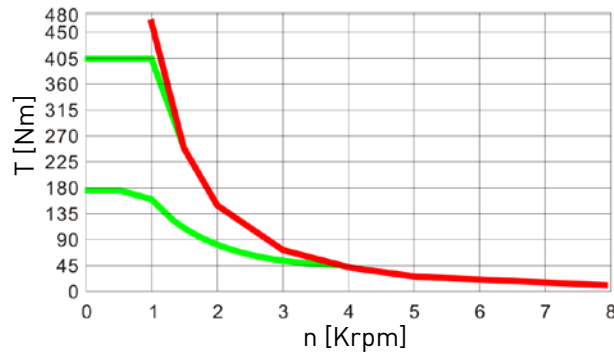
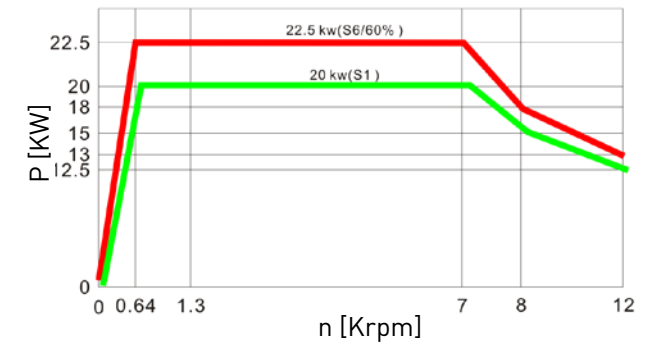
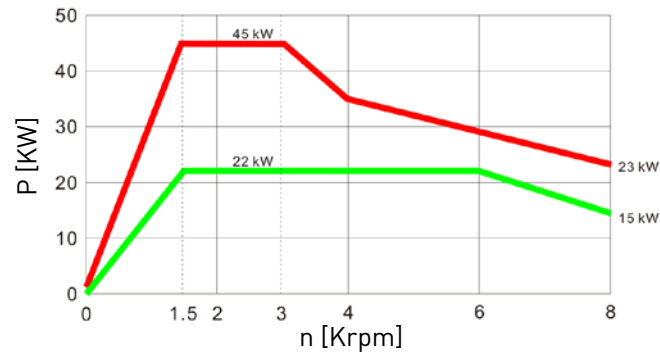
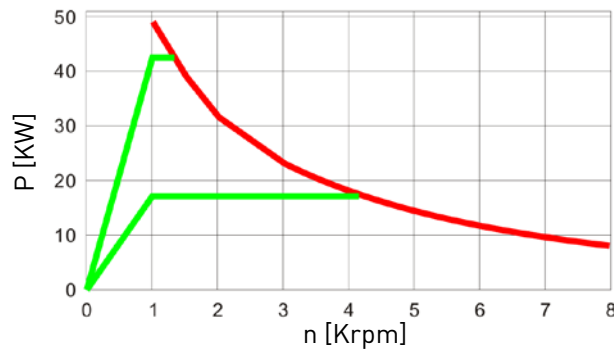

BT50/SK50-6000 rpm-SIEMENS

BT50/SK50-6000 rpm-FANUC

HSK A100-12000rpm-SIEMENS

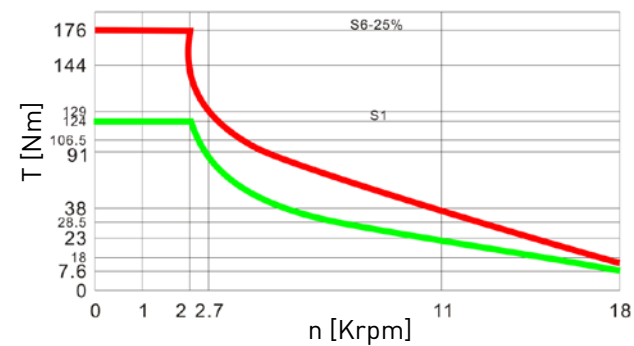
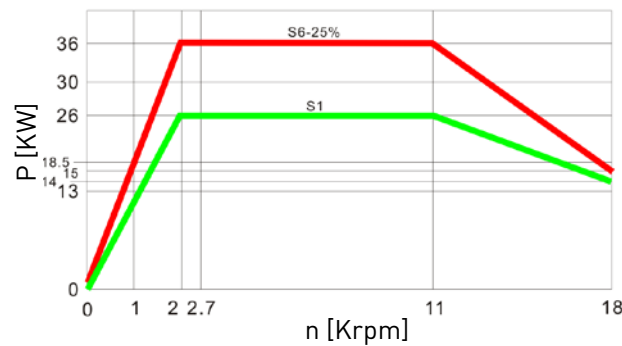

HSK A63-18000rpm-SIEMENS

OPTIONS



Tool and workpiece probe



CTS coolant through spindle



Manual 90° milling head

DIMENSIONS OF V3320

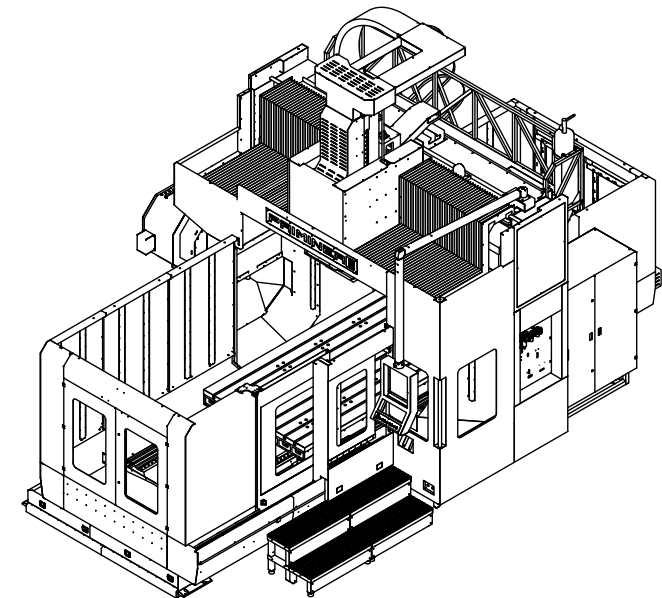
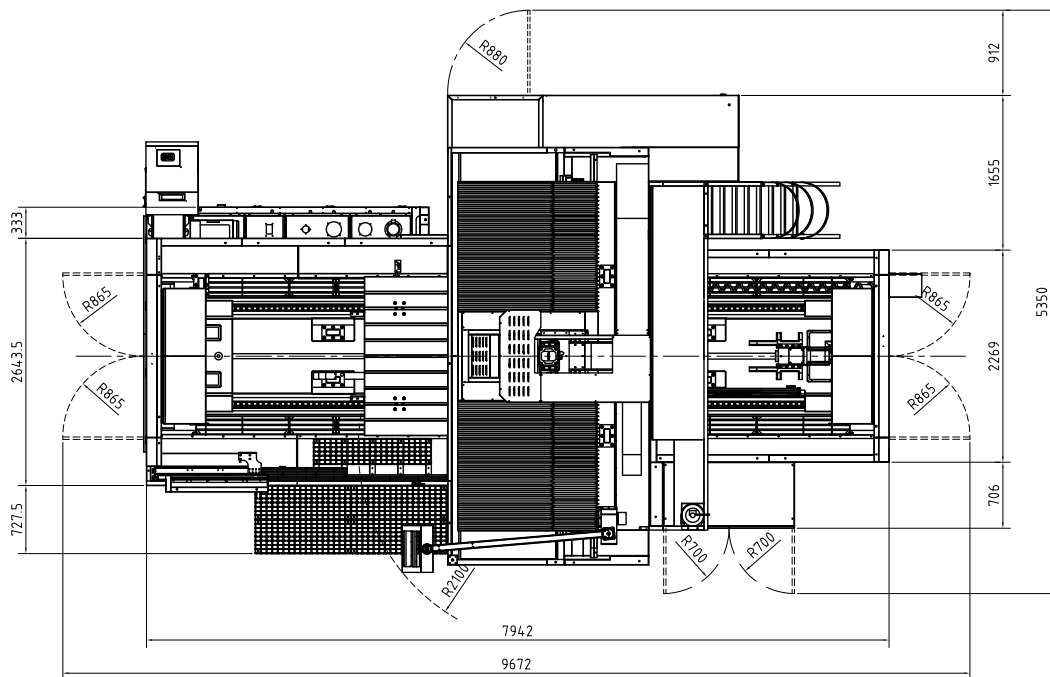
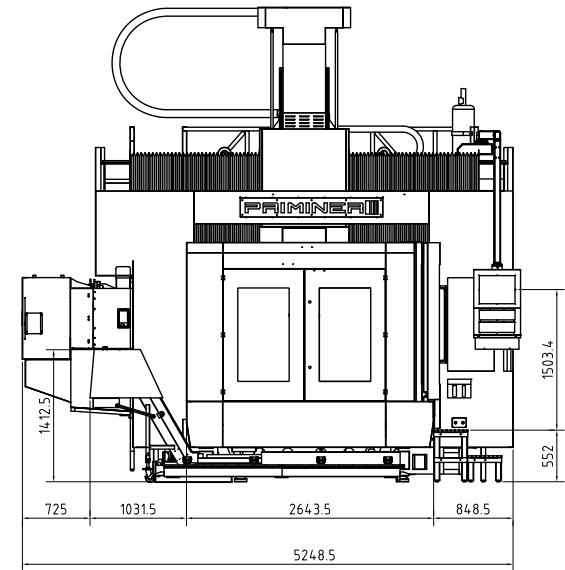
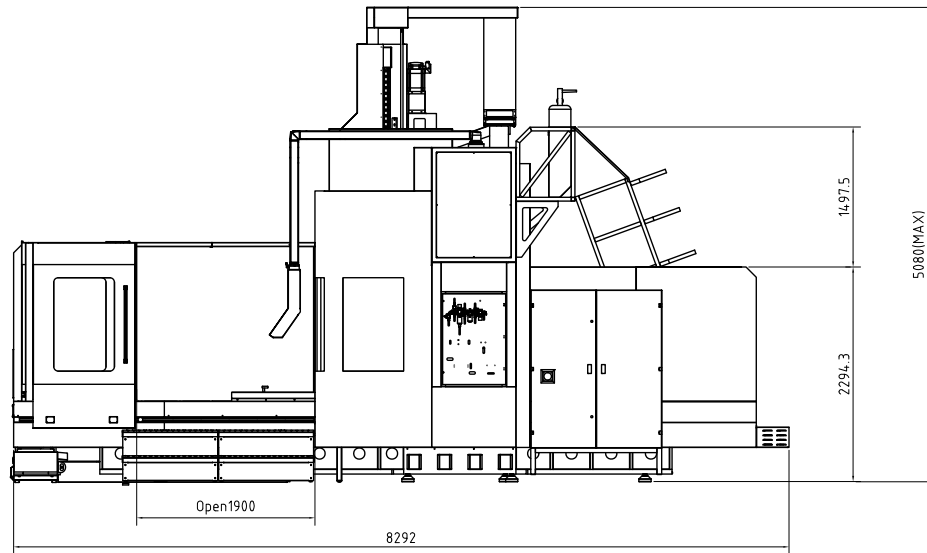

DIMENSIONS OF V4020

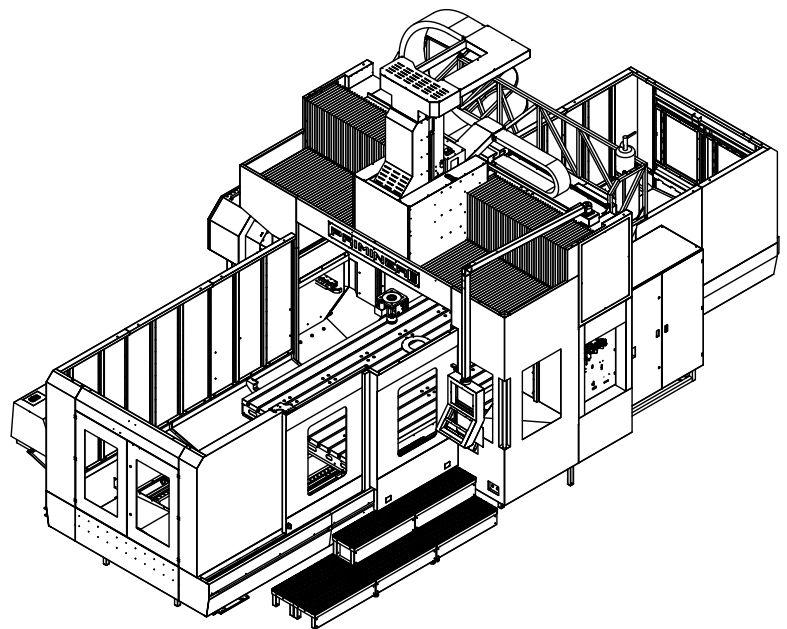
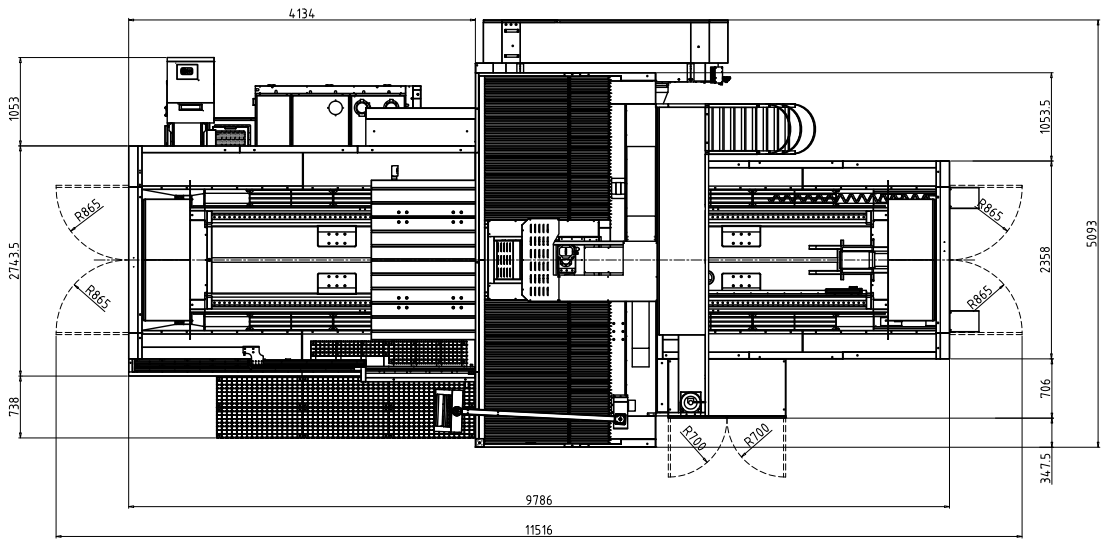
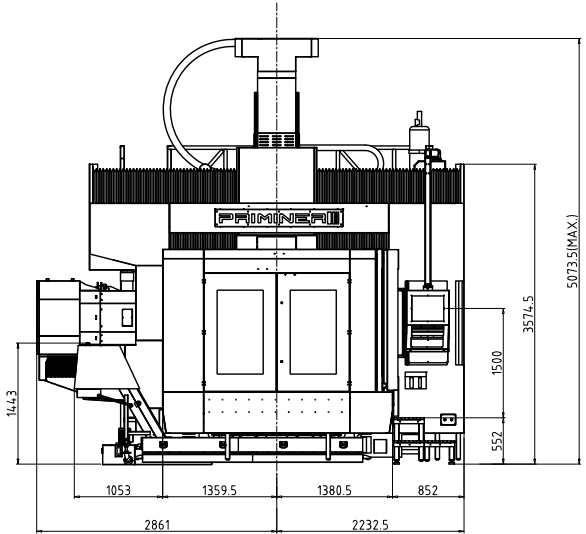
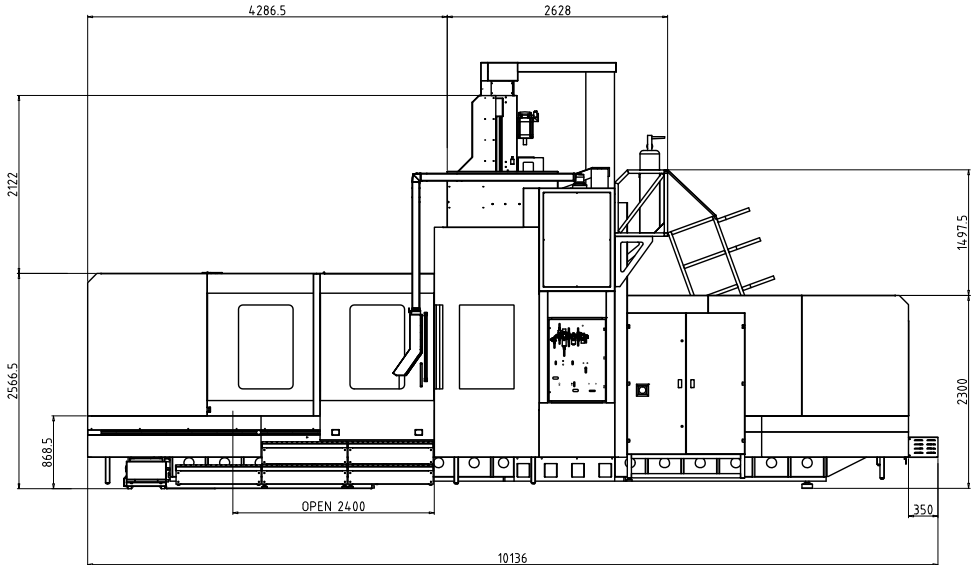





IMINER Global TEAM

PRIMINER Solutions



hyperMILL

SolidCAM
The Leaders in Integrated CAM



DIJET NS TOOL

GÜHRING



PL LEHMANN



SCHUNK



HAIMER



Blaser.
SWISSLUBE



REGO-FIX

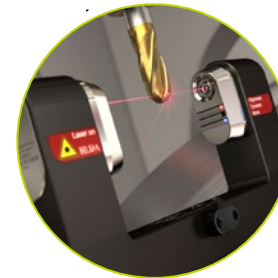

BLUM
focus on productivity



Workpiece measuring by CMM

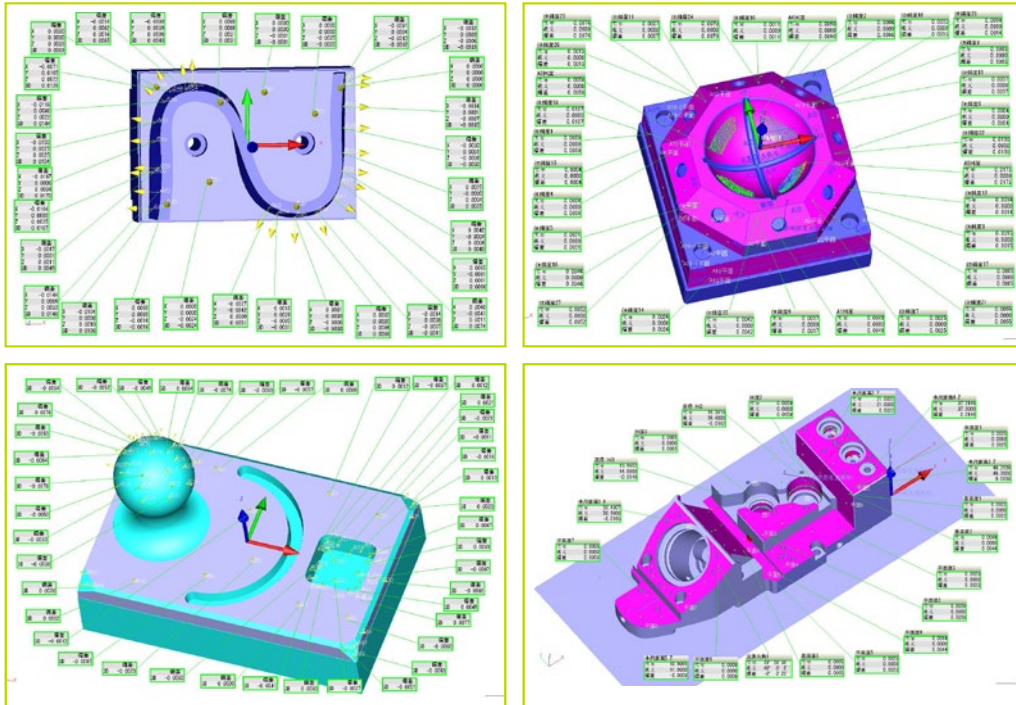

PRIMINER

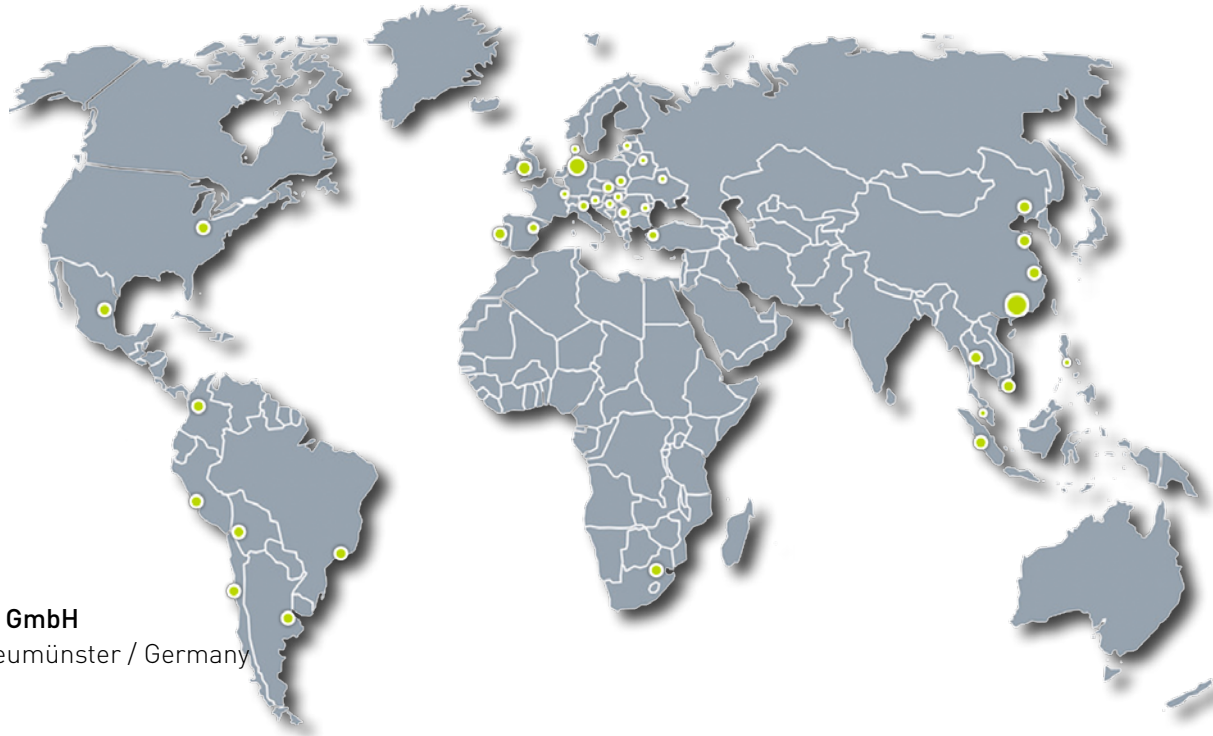

PRIMINER Werkzeugmaschinen GmbH

Gadelander Str. 172 · D-24539 Neumünster / Germany
Tel: +49 (0) 4321-53 9946 -0
Fax: +49 (0) 4321-25 2003 -90
E-mail: info@priminer.de

PRIMINER SOUTH EAST EUROPE · PRIMINER d.o.o. BEOGRAD

Vladimira Popovica 38-40 · GTC - 11070 Beograd / Srbija
Tel: +381 69 702 705
Fax: +381 11 715 69 00
E-mail: office@priminer.de

PRIMINER MACHINE TOOLS DONGGUAN CO., LTD

XinRuYi Industrial Park, Fuxing Road, Xingguang Village, Huangjiang Town, Dongguan, P.R.China
Tel: +86 769 838 490 61
Fax: +86 769 838 490 62
E-mail: sales@priminer.de

www.priminer.de